

SOLDER CUP CONTACTS

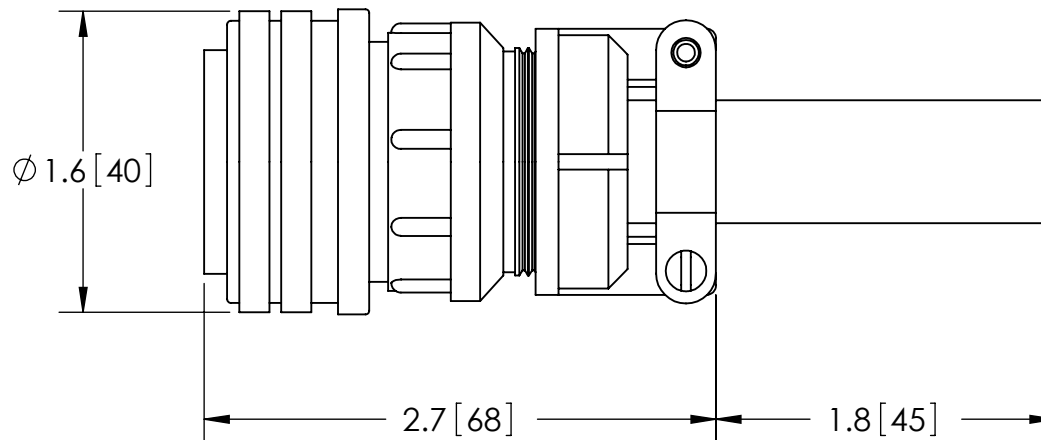

RATINGS	
VOLTAGE:	700 V DC
CURRENT:	46 AMPS
TEMPERATURE:	-55°C TO 125°C

WWW.SOLIDSEALING.COM

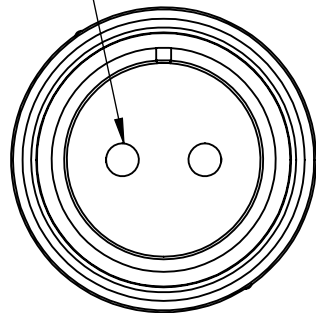

SOLID SEALING TECHNOLOGY, INC.

SALES DWG NO. KT24963SL REV. A1

PROPRIETARY AND CONFIDENTIAL

THE INFORMATION CONTAINED IN THIS DRAWING IS THE SOLE PROPERTY OF SOLID SEALING TECHNOLOGY. ANY REPRODUCTION IN PART OR AS A WHOLE WITHOUT THE WRITTEN PERMISSION OF SOLID SEALING TECHNOLOGY IS PROHIBITED.

THIRD ANGLE PROJECTION

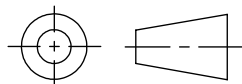

TITLE:

2 PIN AIR SIDE PLUG

PART NO. KT24963 REV. A

REV.	APP'D	DATE	SCALE 1:1	DIMENSIONS IN INCHES [mm]	DRAWN	JS	07/27/2011
A1	JS	07/27/2011	ME0053-11SM KT24963		ENG APPR.	JS	07/27/2011

DIMENSIONS ARE FOR REFERENCE ONLY. UNLESS NOTED, NO TOLERANCES ARE IMPLIED. CONSULT SST TO DISCUSS YOUR SPECIFIC REQUIREMENTS.