

MATING FLANGE MINIMUM ID IS  $\varnothing 2.50$

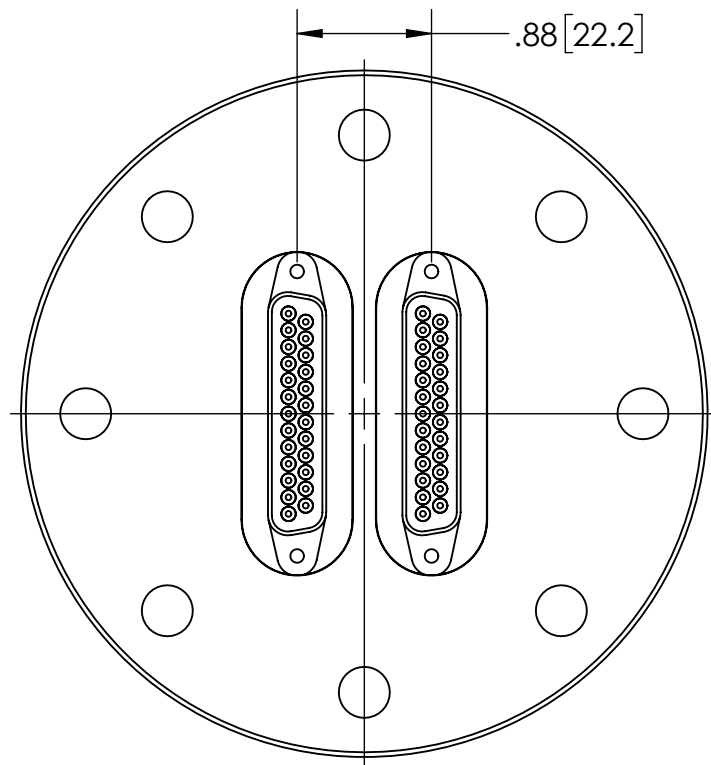

$\varnothing .04 [1.0]$   
GOLD PLATED  
STN STL  
CONDUCTORS

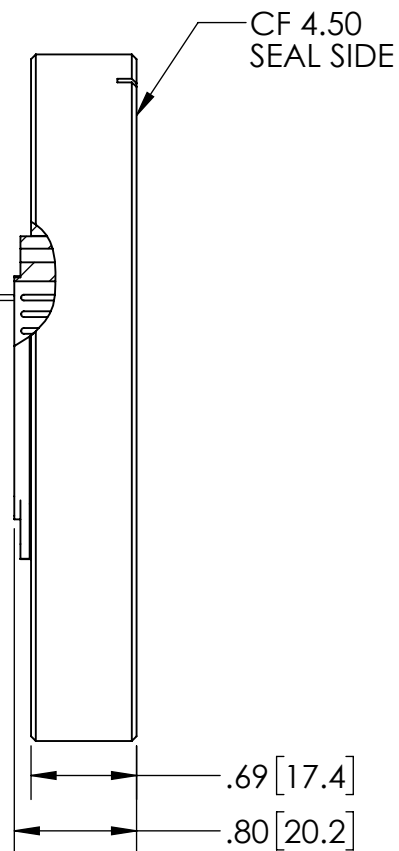

PLUGS SOLD SEPARATELY:  
-VACUUM SIDE PEEK PLUG FA13605  
-AIR SIDE PLUG KT14878

#### PERFORMANCE SPECIFICATIONS

VOLTAGE:	500V DC
CURRENT:	3 AMPS
PRESSURE:	1200 PSIG @ 20°C
TEMPERATURE:	-269°C TO 450°C

#### PROPRIETARY AND CONFIDENTIAL

THE INFORMATION CONTAINED IN THIS DRAWING IS THE SOLE PROPERTY OF SOLID SEALING TECHNOLOGY. ANY REPRODUCTION IN PART OR AS A WHOLE WITHOUT THE WRITTEN PERMISSION OF SOLID SEALING TECHNOLOGY IS PROHIBITED.

#### THIRD ANGLE PROJECTION

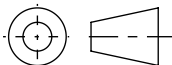

#### TITLE

(2) 25 PIN SUB D CONNECTORS



**SOLID SEALING**  
TECHNOLOGY

REV.	APP'D	DATE	SCALE 4:5	DIMENSIONS IN INCHES [mm]	DRAWN	JF	04/18/2014
C5	JF	05/02/2025	MPCL0091-01		ENG APPR.	JF	04/18/2014

PART NO. FA14340 REV. C

WWW.SOLIDSEALING.COM

SALES DWG NO. FA14340SL REV. C5

***DIMENSIONS ARE FOR REFERENCE ONLY. UNLESS NOTED, NO TOLERANCES ARE IMPLIED. CONSULT SST TO DISCUSS YOUR SPECIFIC REQUIREMENTS.***