

PART NO.	AIR SIDE PLUG
FA23247	NO
KT23247	YES

RATINGS	
VOLTAGE:	1.5KV DC
CURRENT:	5 AMPS
PRESSURE:	500 PSIG @ 20°C
TEMPERATURE WITHOUT PLUG:	-80°C TO 450°C*
TEMPERATURE WITH PLUG:	-65°C TO 165°C

*CALL SST TO CONFIRM LOWER TEMPERATURE USE

WWW.SOLIDSEALING.COM



SOLID SEALING TECHNOLOGY, INC.

SALES DWG NO. FA23247SL REV. B1

PROPRIETARY AND CONFIDENTIAL

THE INFORMATION CONTAINED IN THIS DRAWING IS THE SOLE PROPERTY OF SOLID SEALING TECHNOLOGY. ANY REPRODUCTION IN PART OR AS A WHOLE WITHOUT THE WRITTEN PERMISSION OF SOLID SEALING TECHNOLOGY IS PROHIBITED.

THIRD ANGLE PROJECTION

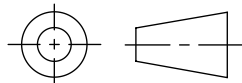

TITLE:

50 OHM TYPE N DOUBLE ENDED

PART NO. FA23247 REV. B

REV.	APP'D	DATE	SCALE 1:1	DIMENSIONS IN INCHES [mm]	DRAWN	JS	07/14/2010
B1	JS	10/19/2012	COTN0025-16		ENG APPR.	JS	07/14/2010