

PLUG BODY: MOLDED SILICONE RUBBER

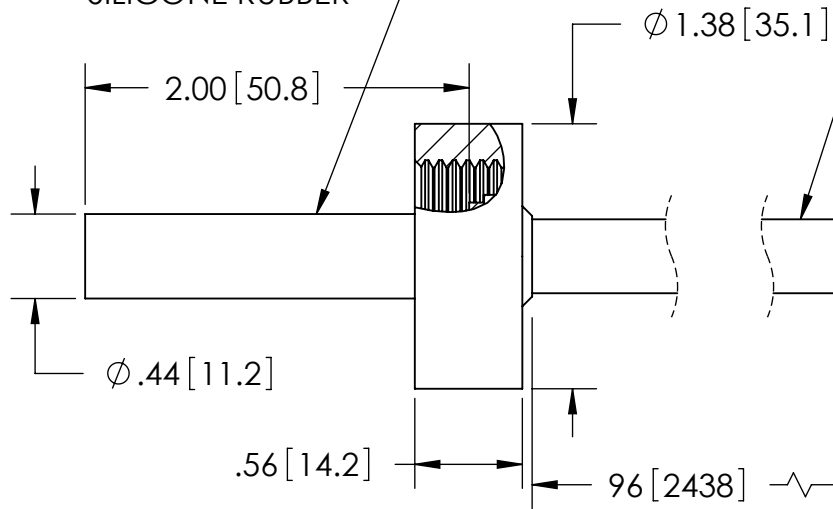

RATINGS	
VOLTAGE:	50KV DC
CURRENT:	10 AMPS
PRESSURE:	400 PSIG @ 20°C
TEMPERATURE WITHOUT PLUG:	-80°C TO 450°C*
TEMPERATURE WITH PLUG:	-55°C TO 125°C

*CALL SST TO CONFIRM LOWER TEMPERATURE USE

AIR SIDE PLUG/CABLE ASSEMBLY INCLUDED

WWW.SOLIDSEALING.COM



SOLID SEALING TECHNOLOGY, INC.

SALES DWG NO. KT21640SL REV. A2

PROPRIETARY AND CONFIDENTIAL

THE INFORMATION CONTAINED IN THIS DRAWING IS THE SOLE PROPERTY OF SOLID SEALING TECHNOLOGY. ANY REPRODUCTION IN PART OR AS A WHOLE WITHOUT THE WRITTEN PERMISSION OF SOLID SEALING TECHNOLOGY IS PROHIBITED.

THIRD ANGLE PROJECTION

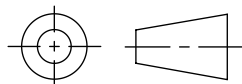

TITLE:

50KV CONNECTOR

PART NO. KT21640 REV. A

REV.	APP'D	DATE	SCALE 1:1	DIMENSIONS IN INCHES [mm]	DRAWN	JS	01/07/2011
A2	JF	04/05/2019	FTCL0147-11		ENG APPR.	JS	12/16/2013

DIMENSIONS ARE FOR REFERENCE ONLY. UNLESS NOTED, NO TOLERANCES ARE IMPLIED. CONSULT SST TO DISCUSS YOUR SPECIFIC REQUIREMENTS.