

PLUG BODY: MOLDED SILICONE RUBBER

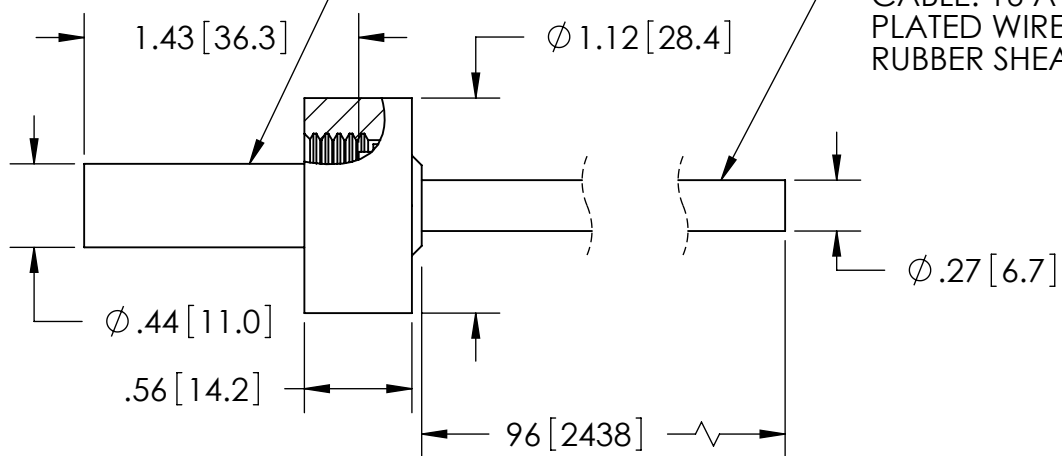

AIR SIDE PLUG/CABLE ASSEMBLY INCLUDED

CABLE: 16 AWG SILVER OR TIN PLATED WIRE WITH SILICONE RUBBER SHEATH, COLOR-WHITE

RATINGS	
VOLTAGE:	30KV DC
CURRENT:	10 AMPS
PRESSURE:	0 PSIG @ 20°C*
TEMPERATURE WITHOUT PLUG:	-25°C TO 205°C
TEMPERATURE WITH PLUG:	-25°C TO 125°C

\* FOR INTERNAL PRESSURE 5 TO 100 PSIG AN OVERPRESSURE RING IS REQUIRED.

[WWW.SOLIDSEALING.COM](http://WWW.SOLIDSEALING.COM)



SOLID SEALING TECHNOLOGY, INC.

SALES DWG NO. KT22002SL REV. B2

PROPRIETARY AND CONFIDENTIAL

THE INFORMATION CONTAINED IN THIS DRAWING IS THE SOLE PROPERTY OF SOLID SEALING TECHNOLOGY. ANY REPRODUCTION IN PART OR AS A WHOLE WITHOUT THE WRITTEN PERMISSION OF SOLID SEALING TECHNOLOGY IS PROHIBITED.

THIRD ANGLE PROJECTION

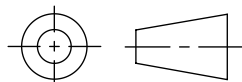

TITLE:

30KV CONNECTOR

PART NO. KT22002 REV. B

REV.	APP'D	DATE	SCALE 1:1	DIMENSIONS IN INCHES [mm]	DRAWN	JS	12/16/2013
B2	JF	04/05/2019	FTCL0147-14		ENG APPR.	JS	12/16/2013

**DIMENSIONS ARE FOR REFERENCE ONLY. UNLESS NOTED, NO TOLERANCES ARE IMPLIED. CONSULT SST TO DISCUSS YOUR SPECIFIC REQUIREMENTS.**