

NOTES:

1- USED ON $\frac{1}{16}$ " TO $\frac{3}{8}$ " OD PINCH TUBE ASSEMBLIES

2- RECOMMENDED TO BE USED TO PINCH COPPER (.032" WALL) AND NICKEL (.035" WALL) TUBES. TUBES SHOULD BE ANNEALED.

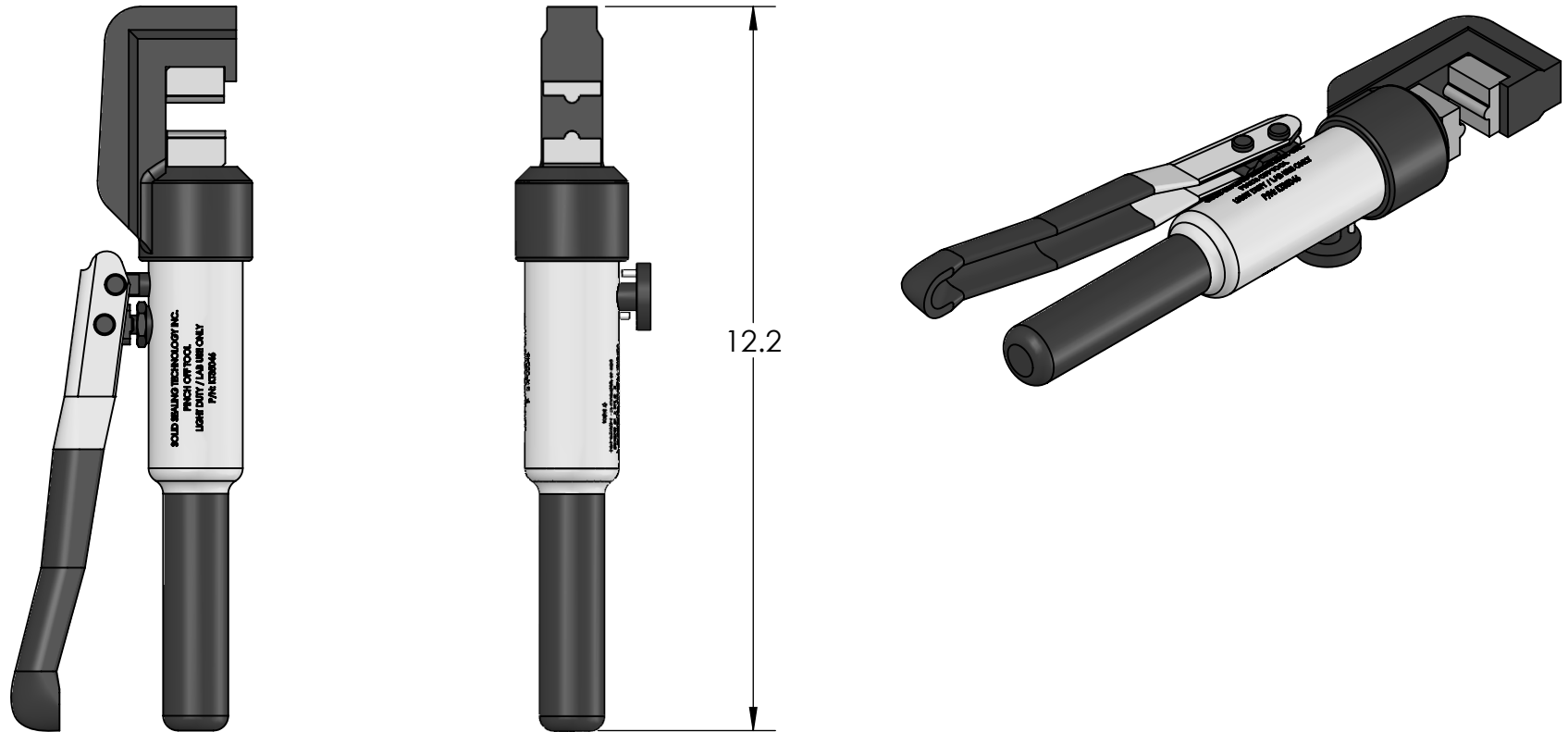

PROPRIETARY AND CONFIDENTIAL

THE INFORMATION CONTAINED IN THIS DRAWING IS THE SOLE PROPERTY OF SOLID SEALING TECHNOLOGY. ANY REPRODUCTION IN PART OR AS A WHOLE WITHOUT THE WRITTEN PERMISSION OF SOLID SEALING TECHNOLOGY IS PROHIBITED.

THIRD ANGLE
PROJECTION

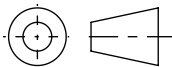

TITLE

HYDRAULIC PINCH OFF TOOL



SOLID SEALING
TECHNOLOGY

REV.	APP'D	DATE	SCALE 1:3	DIMENSIONS IN INCHES [mm]	DRAWN	MH	12/20/2016
A5	JF	7/26/2024	MSME0079-11		ENG APPR.	MH	12/20/2016

PART NO. KT35046 REV. A

WWW.SOLIDSEALING.COM

SALES DWG NO. KT35046SL REV. A5

DIMENSIONS ARE FOR REFERENCE ONLY. UNLESS NOTED, NO TOLERANCES ARE IMPLIED. CONSULT SST TO DISCUSS YOUR SPECIFIC REQUIREMENTS.