

PLUG BODY: MOLDED SILICONE RUBBER

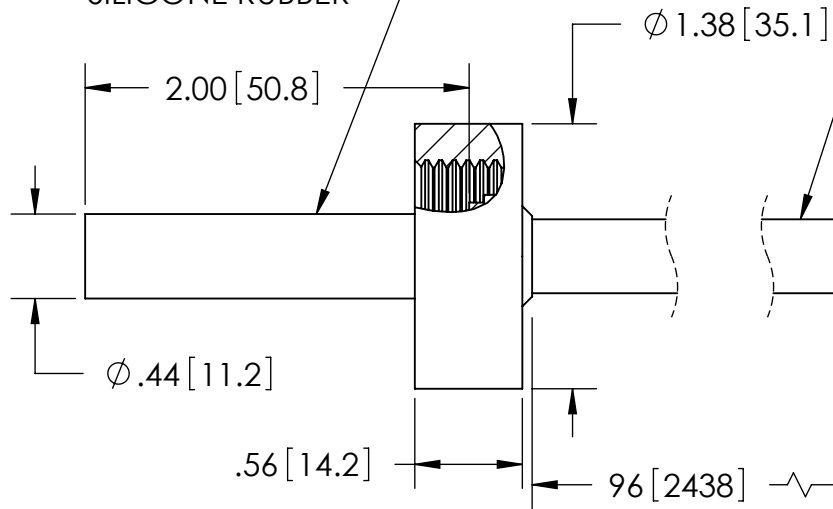

CABLE: 14 AWG SILVER OR TIN PLATED WIRE WITH SILICONE RUBBER SHEATH, COLOR-BLUE

Ø .39 [9.8]

PERFORMANCE SPECIFICATIONS	
VOLTAGE:	50KV DC
CURRENT:	10 AMPS
PRESSURE:	400 PSIG @ 20°C
TEMPERATURE WITHOUT PLUG:	-80°C TO 450°C*
TEMPERATURE WITH PLUG:	-55°C TO 125°C

\*CALL SST TO CONFIRM LOWER TEMPERATURE USE

AIR SIDE PLUG/CABLE ASSEMBLY INCLUDED

PROPRIETARY AND CONFIDENTIAL

THE INFORMATION CONTAINED IN THIS DRAWING IS THE SOLE PROPERTY OF SOLID SEALING TECHNOLOGY. ANY REPRODUCTION IN PART OR AS A WHOLE WITHOUT THE WRITTEN PERMISSION OF SOLID SEALING TECHNOLOGY IS PROHIBITED.

THIRD ANGLE PROJECTION

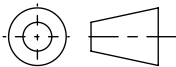

TITLE

50KV CONNECTOR



REV.	APP'D	DATE	SCALE 1:1	DIMENSIONS IN INCHES [mm]	DRAWN	JF	11/28/2022
A1	JF	11/28/2022	FTCL0147-22		ENG APPR.	JF	11/28/2022

PART NO. KT44581 REV. A

WWW.SOLIDSEALING.COM

SALES DWG NO. KT44581SL REV. A1

**DIMENSIONS ARE FOR REFERENCE ONLY. UNLESS NOTED, NO TOLERANCES ARE IMPLIED. CONSULT SST TO DISCUSS YOUR SPECIFIC REQUIREMENTS.**