

ACCEPTS  
 $\phi$ .142 [3.61] PIN

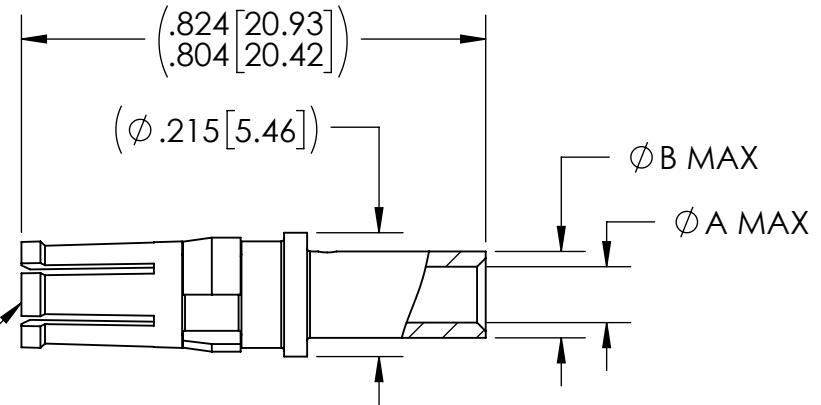

PART NUMBER	WIRE SIZE	$\phi$ A MAX	$\phi$ B MAX	CURRENT RATING	TEMPERATURE
FP39118	12 AWG	.100 [2.54]	.218 [5.54]	20 AMPS	-200°C TO 200°C
FP39118-02	16 AWG	.067 [1.70]	.102 [2.59]	10 AMPS	

[WWW.SOLIDSEALING.COM](http://WWW.SOLIDSEALING.COM)



**SOLID SEALING TECHNOLOGY, INC.**

SALES DWG NO. FP39118SL REV. A1

PROPRIETARY AND CONFIDENTIAL

THE INFORMATION CONTAINED IN THIS DRAWING IS THE SOLE PROPERTY OF SOLID SEALING TECHNOLOGY. ANY REPRODUCTION IN PART OR AS A WHOLE WITHOUT THE WRITTEN PERMISSION OF SOLID SEALING TECHNOLOGY IS PROHIBITED.

THIRD ANGLE PROJECTION

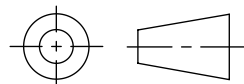

TITLE:

POWER CRIMP CONTACT

PART NO. (SEE TABLE) REV. A

REV.	APP'D	DATE	SCALE 3:1	DIMENSIONS IN INCHES [mm]	DRAWN	JF	11/26/2019
A1	JF	11/26/2019	ACNCT044-1ST		ENG APPR.	JF	11/26/2019

**DIMENSIONS ARE FOR REFERENCE ONLY. UNLESS NOTED, NO TOLERANCES ARE IMPLIED. CONSULT SST TO DISCUSS YOUR SPECIFIC REQUIREMENTS.**